



BROOK GAMBLE



Flat 4 Aymond Grange 12 Dittons Road , Eastbourne, BN21 1DW

Brook Gamble are delighted to be offering this extremely well presented, one bedroom first floor converted apartment in the highly sought after Saffrons area of Eastbourne, and ideally located within easy reach of Eastbourne Town Centre, and mainline railway station. A beautifully decorated, spacious apartment with large welcoming lounge, kitchen, bedroom with walk in wardrobe area and bathroom. also benefitting from its own private garage which is essential in this location, and being offered with a share in the freehold. Viewing is by appointment with the sellers sole agents.

£205,000

Flat 4 Aymond Grange 12 Dittons Road , Eastbourne, BN21 1DW



- Delightful One Bedroom Converted Apartment
- Share In Freehold
- Tasteful Decor Throughout
- Favoured Saffrons Location
- Garage
- Close to Station
- First Floor
- Spacious Lounge

Accommodation Comprising

Leasehold Information

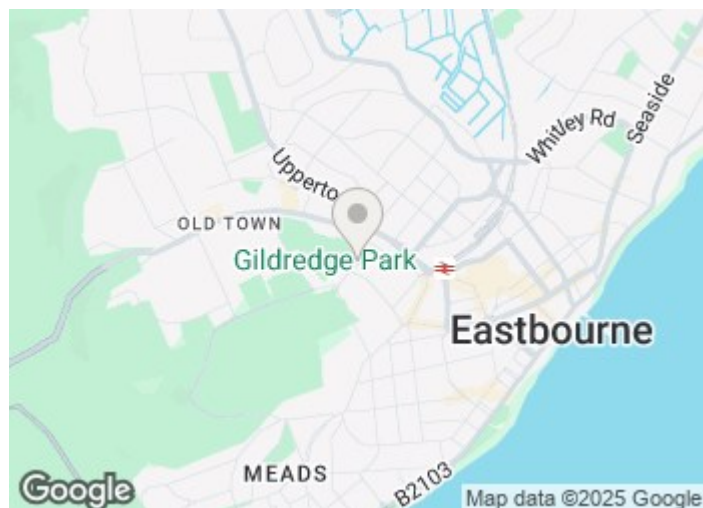

Directions



Floor Plan

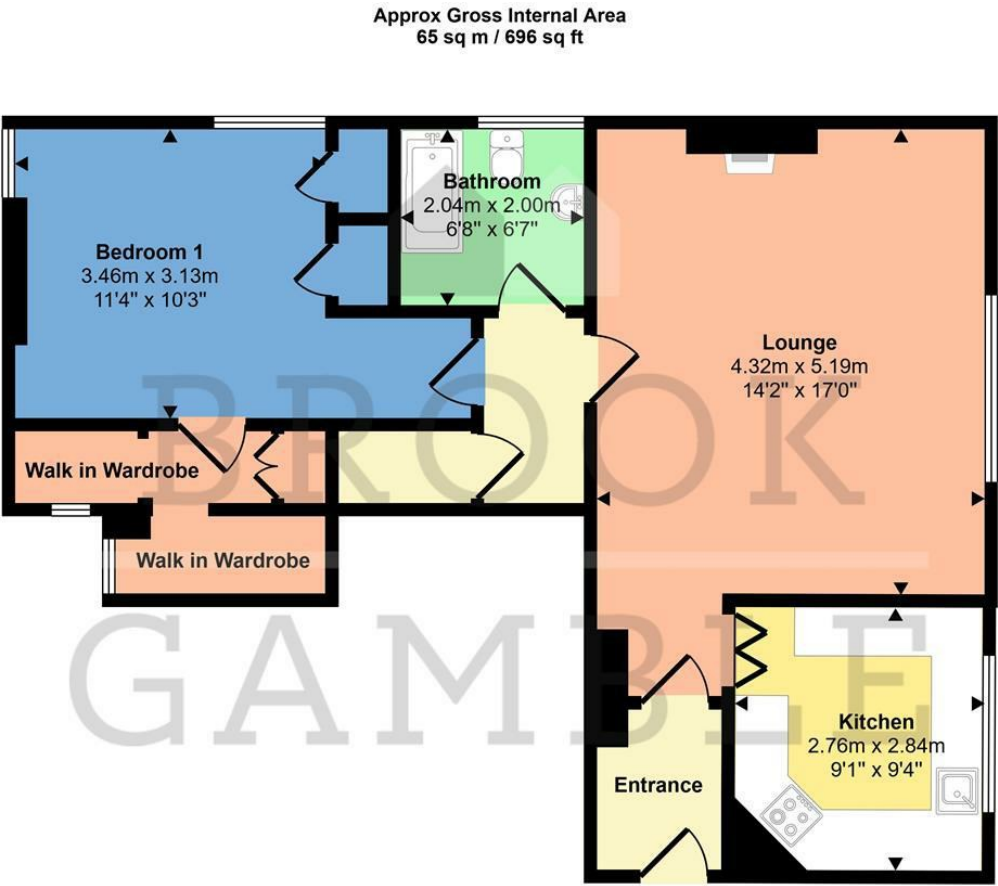

Floorplan

This floorplan is only for illustrative purposes and is not to scale. Measurements of rooms, doors, windows, and any items are approximate and no responsibility is taken for any error, omission or mis-statement. Icons of items such as bathroom suites are representations only and may not look like the real items. Made with Made Snappy 360.

These particulars, whilst believed to be accurate are set out as a general outline only for guidance and do not constitute any part of an offer or contract. Intending purchasers should not rely on them as statements of representation of fact, but must satisfy themselves by inspection or otherwise as to their accuracy. No person in this firms employment has the authority to make or give any representation or warranty in respect of the property.

